

Sherman Parc

Jackson

Sherman Parc offers you a tranquil rural setting while being in close proximity to a wide selection of shopping, dining and recreational opportunities. Plus, you can gear-up at the Cabela's Mega Store just a few short miles away! This community also is served by the highly rated Germantown School District. Commuting is easy as Sherman Parc is located just off of HWY 45 and HWY 60 in the Town of Jackson.

Tim O'Brien Homes offers a wide variety of 1/2 acre homesites that are currently available, including many with walk-out and look-out exposures. You'll enjoy the many acres of green space as well as the gently winding streets that make Sherman Parc a place you'll be proud to call Home.

Homesite selection will never be better as new home construction is just under way in this beautiful Washington County community! Give us a call today at 262.542.5750 to tour the community!

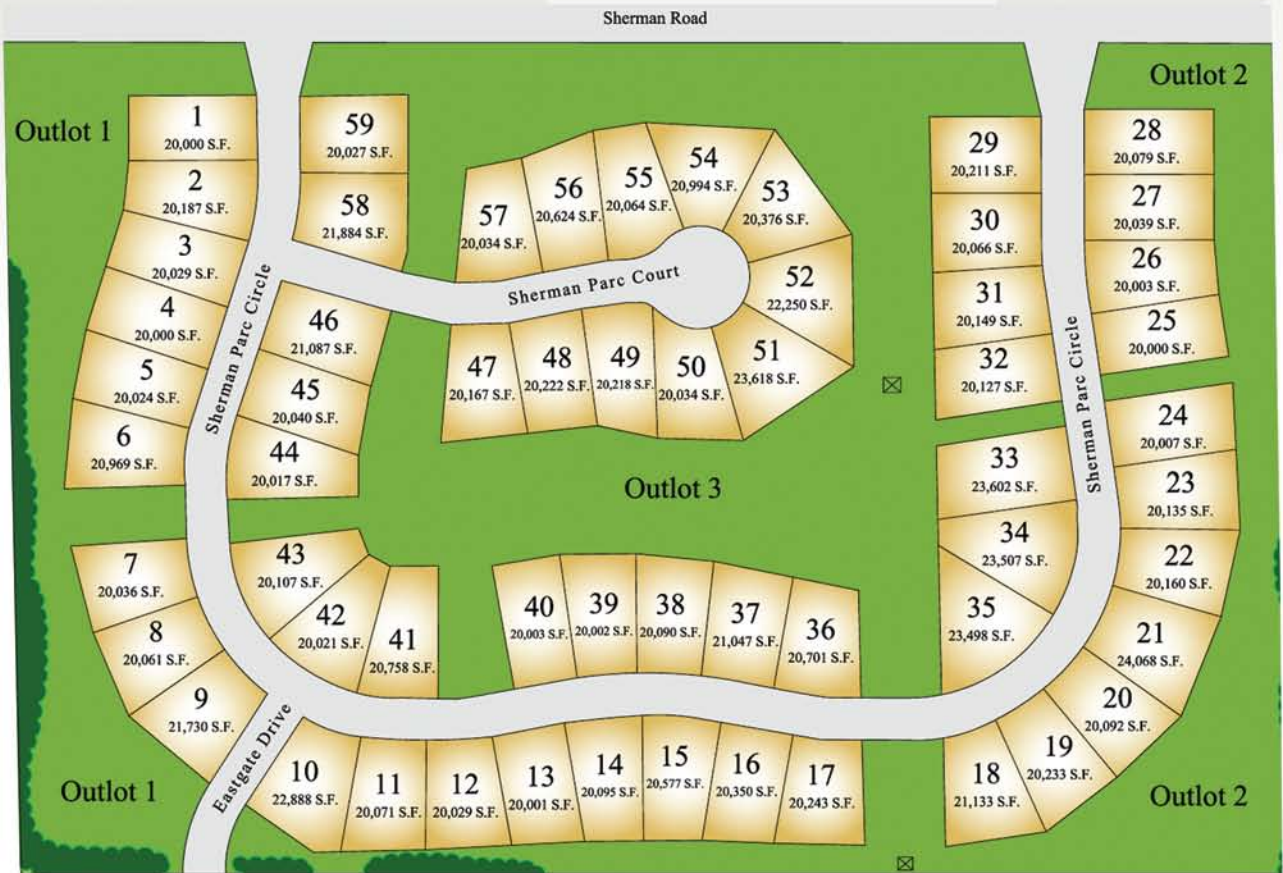

PLEASE SEE REVERSE SIDE FOR LOT AND PRICE LISTINGS.

 Numbered lots available from Tim O'Brien Homes. Please ask about other lots available.

Hwy 45 to Hwy 145 exit, east to Hwy P, north to Sherman Rd., east to Sherman Parc Circle (entrance to Sherman Parc Circle).

Home & Lot Complete starting in \$230s.

TIM O'BRIEN homes

Building for the way you live

Visit us online at: TimOBrienHomes.com

N16 W24132 Prairie Court, Suite 220 • Waukesha, WI 53188

262-542-5750 • Fax 262-542-9780

